



User Guide

Wallbox



Wallbox Overview

Accessories of Mode C

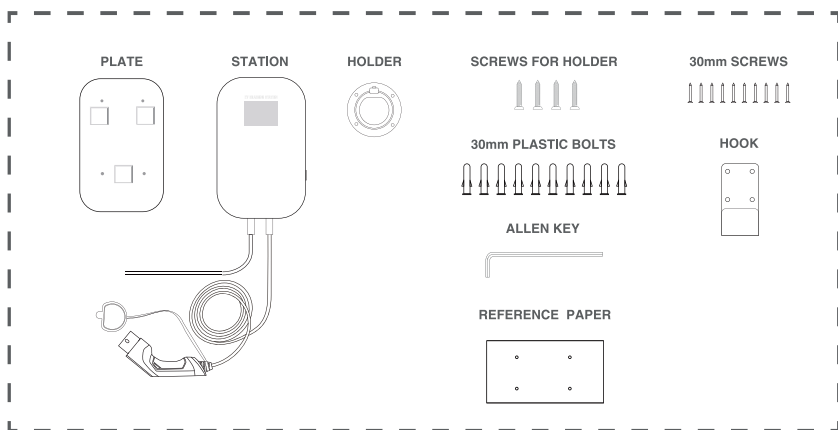

Mode C Station Overview

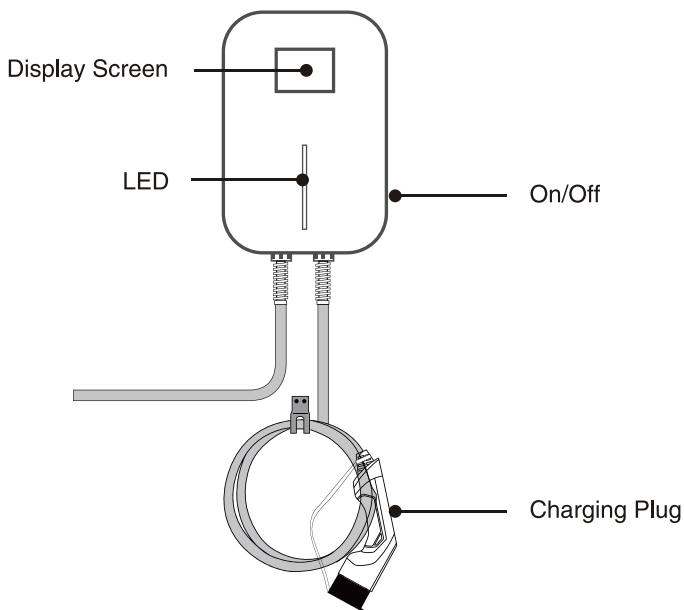

Level 2 EV Charging Station

Phase Mode: Single Phase
 Installation Method: Wall/Stand
 Mode: C(with plug)
 Certificate: CE
 IP Rating: IP66
 Rated Voltage: 230VAC \pm 10%
 Rated Current: 16/32A
 Maximum Power: 3.84/7.68KW
 Operating Temperature: -25 $^{\circ}$ C ~ 55 $^{\circ}$ C
 Enclosure Material: ABS+PC alloy
 Start Mode: Button(default)
 Warranty: 1 Year

Phase Mode: Three Phase
 Installation Method: Wall/Stand
 Mode: C(with plug)
 Certificate: CE
 IP Rating: IP66
 Rated Voltage: 380VAC \pm 10%
 Rated Current: 16/32A
 Maximum Power: 11/22KW
 Operating Temperature: -25 $^{\circ}$ C +55 $^{\circ}$ C
 Enclosure Station Material: ABS+PC alloy
 Start Mode: Button(default)
 Warranty: 1 Year

Instruction for Use

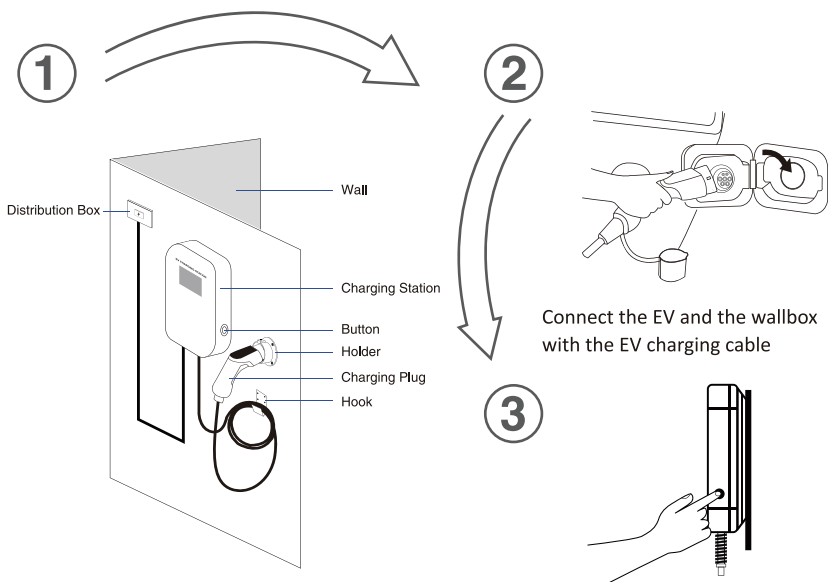

Make sure the wallbox is connected to power

Press the button on the right side of the wallbox to start/stop charging

◆ Hang the cable on the hook when it is not in use

Installation Guide

①

REFERENCE PAPER
of installing screw hole size

Wall

Drill the holes
according to the
REFERENCE PAPER

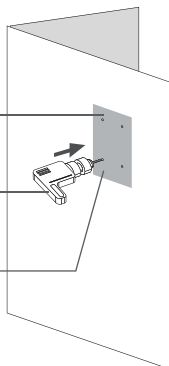

②

Hammer the
30mm PLASTIC BOLTS
into the holes

Take down the
REFERENCE PAPER
from the wall later

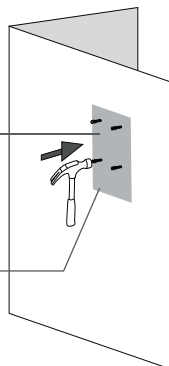

③

Fix the PLATE
with 30mm SCREWS
on the wall

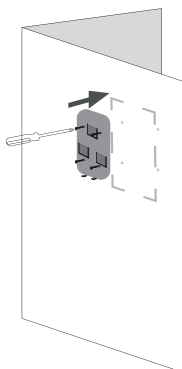

④

Embed STATION
into PLATE on the wall

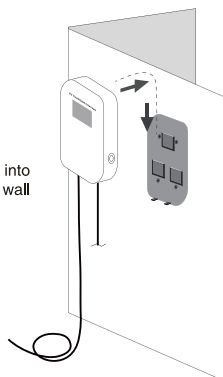

⑤

This is the final completion pic,
you can put the HOOK
and HOLDER
anywhere you need

The cable can
be hung on the
HOOK and HOLDER

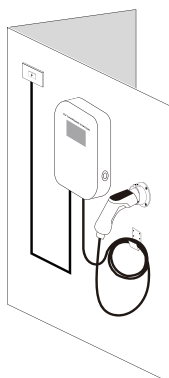

⑥

Tear off the protector

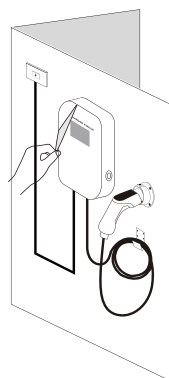

Wallbox Overview

Accessories of Mode A

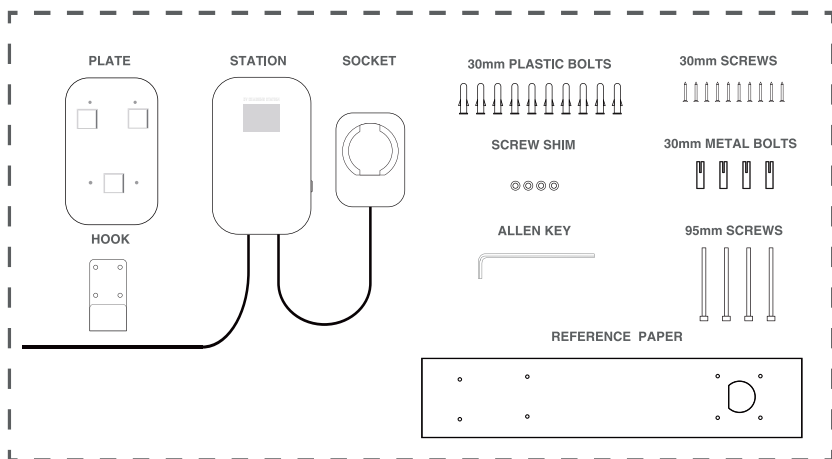

Mode A Station Overview

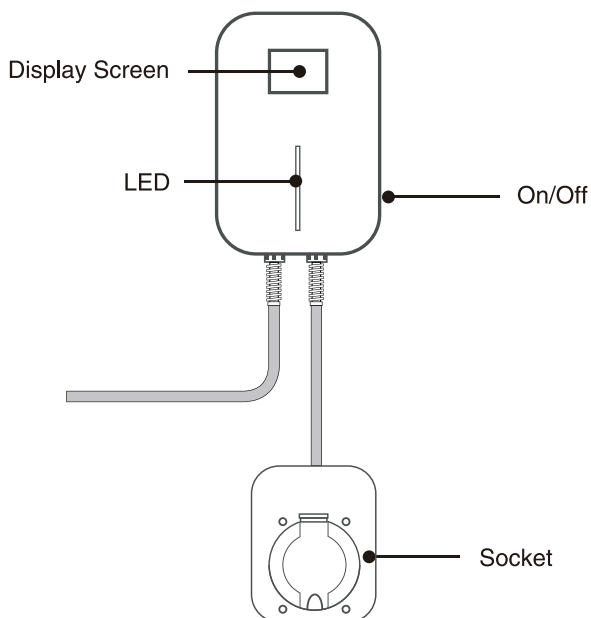

Level 2 EV Charging Station

Phase Mode: Single Phase
 Installation Method: Wall/Stand
 Mode: A(with outlet)
 Certificate: CE
 IP Rating: IP66
 Rated Voltage: 230VAC \pm 10%
 Rated Current: 16/32A
 Maximum Power: 3.84/7.68KW
 Operating Temperature: -25 $^{\circ}$ C ~ 55 $^{\circ}$ C
 Enclosure Material: ABS+PC alloy
 Start Mode: Button(default)
 Warranty: 1 Year

Phase Mode: Three Phase
 Installation Method: Wall/Stand
 Mode: A(with outlet)
 Certificate: CE
 IP Rating: IP66
 Rated Voltage: 380VAC \pm 10%
 Rated Current: 16/32A
 Maximum Power: 11/22KW
 Operating Temperature: -25 $^{\circ}$ C +55 $^{\circ}$ C
 Enclosure Material: ABS+PC alloy
 Start Mode: Button(default)
 Warranty: 1 Year

Instruction for Use

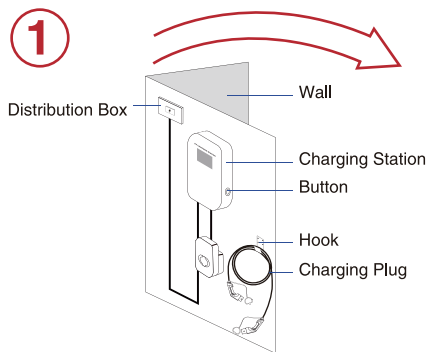

Make sure the walbox is connected to power

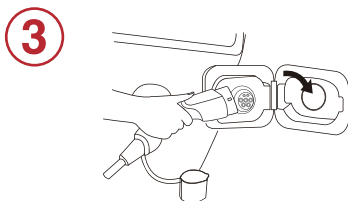
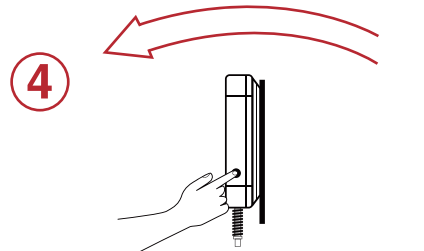
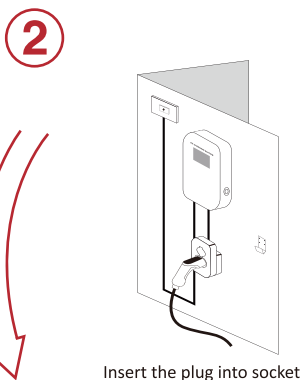

◆ Hang the cable on the hook when it is not in use

Installation Guide

①

REFERENCE PAPER
of installing screw hole size

Wall

Drill the holes according to
the REFERENCE PAPER

②

Hammer the
30mm PLASTIC BOLTS
into the holes

Hammer the
30mm METAL BOLTS
into the holes

Take down the
REFERENCE PAPER
from the wall later

③

Fix the PLATE with
30mm SCREWS on the wall

④

Embed STATION
into PLATE on the wall

⑤

Take out the plate from
the body of charging
SOCKET

⑥

Fix the SOCKET on the wall
with 95mm SCREWS
by ALLEN KEY
and put the plate back to the
body of SOCKET

95mm SCREWS

Screw Shim

⑦

Connect the inlet cable and
the power supply correctly

This is the final completion pic,
you can put the HOOK
anywhere you need

The cable can be hung on the
HOOK

⑧

Tear off the protector

SINGLE PHASE

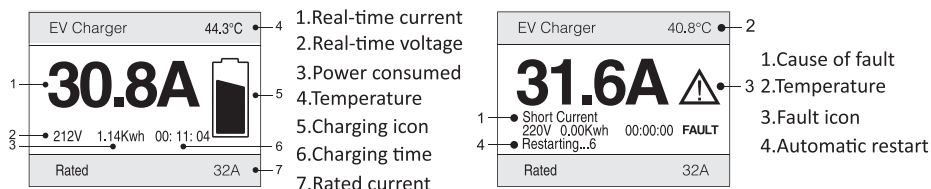

THREE PHASE

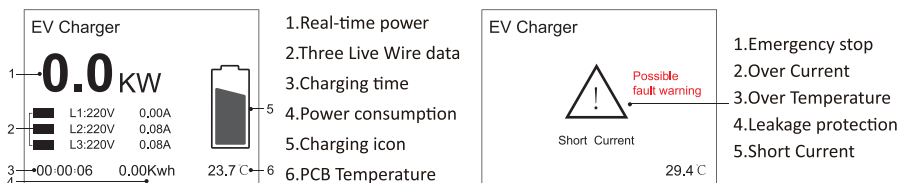
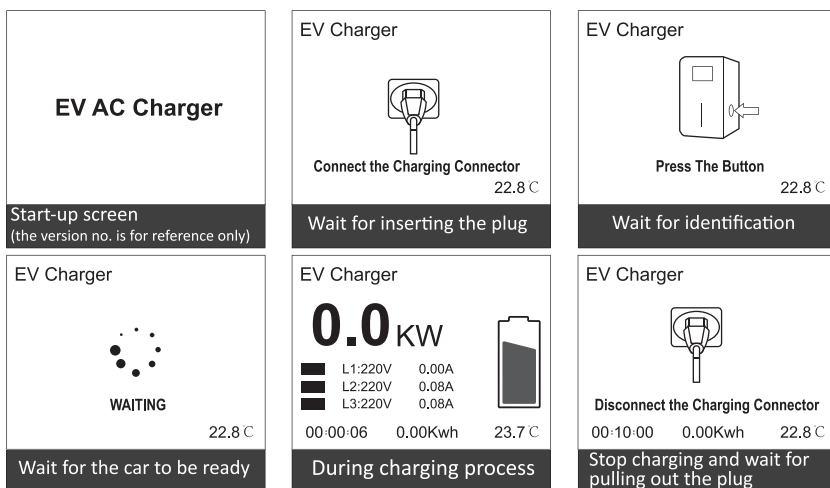

	IDLE	CONNECTED	CHARGING	FINISHED	ERROR
Instruction of LED Status	 OFF	 Continuous light	 Rolling	 Continuous light	 Red flashing

Note: When small problems like short current occur, the wallbox will automatically restart to repair and continue charging.

For serious failures, the system can not automatically recover, in order to remind the user of this failure, after the user pulls the plug, the system will automatically countdown 10 seconds to restart

Failure to follow instructions may result in danger!

▲ Regularly check whether the charging station has visible damage. There may be a electric shock when operating the broken charging station.

▲ Make sure that all safety facilities are available at all times and are tested regularly to ensure they can operate normally.

▲ If a ground fault occurs, it must be assumed that the cable carries voltage. Please confirm that there's no high-voltage power in the system before inspecting the charging station.

▲ Persons who install and use charging stations must obey the principles and regulations mentioned to ensure the personal safety and equipment safety.

▲ Before powering on the device, please confirm that the device is properly grounded to avoid unnecessary accidents.

▲ All tools' unnecessarily exposed metal parts should be insulated to prevent them from touching the metal frame to avoid short circuit.

▲ Do not modify, retrofit, or change any part by yourself under any circumstances.

▲ To ensure the service life and stable operation of the charging station, the operating environment should be kept as clean as possible with a relatively stable temperature and humidity. The charging station must not be used in flammable environment or environments with volatile gas.

▲ Be sure to confirm that the input voltage, frequency, circuit breakers and other conditions of the device meet the specifications before the device is powered on.

Maintenance & Overhaul

In order to ensure the normal service life of the charging station and reduce risk, maintenance must be performed within the specified time. The maintenance of the equipment must be completed by professionals with qualified and safe maintenance tools.

The product is already packed in factory. During transportation, strong impact and bumps should be avoided to avoid damage to the outer packaging of the product.

The product should be placed at an ambient temperature of $-25\text{ }^{\circ}\text{C} \sim 55\text{ }^{\circ}\text{C}$ with a relative humidity of no more than 95%. The air should not contain acids, alkalis or other corrosive gases and explosive gases.

AC charging stations are subject to stringent quality inspections. Mode 2 Charging is subject to stringent quality inspections. From the day of purchase, any problem of product quality can be reflected to the dealer within two years.

Any direct damage or malfunction caused by neglect, incorrect use, installation, usage, repair by the users or natural damage are not covered by the warranty.

